

COMMONWEALTH AC AXIAL FAN

FP-108-1

119x119x38mm VENUS

DESIGN FEATURES

- *BEARING SYSTEM: SLEEVE BEARING & BALL BEARING
- *IMPELLER: PLASTIC WITH FIBER GLASS FILED UL 94V-0
- *HOUSING: DIE CAST ALUMINUM PAINTED BLACK OR NATURAL COLOR PBT PLASTIC UL 94V-0
- *MOTOR: SHADED POLE, IMPEDANCE PROTECTED
- *CONNECTING: TERMINAL & WIRE LEADS
- *SPEED: S-U ULTRA TYPE
 - S-1 HIGH SPEED TYPE
 - S-2 MEDIUM SPEED TYPE
 - S-3 LOW SPEED TYPE
- *OTHER VOLTAGE: 24, 48, 100, 380AC (50/60Hz) ARE AVAILABLE

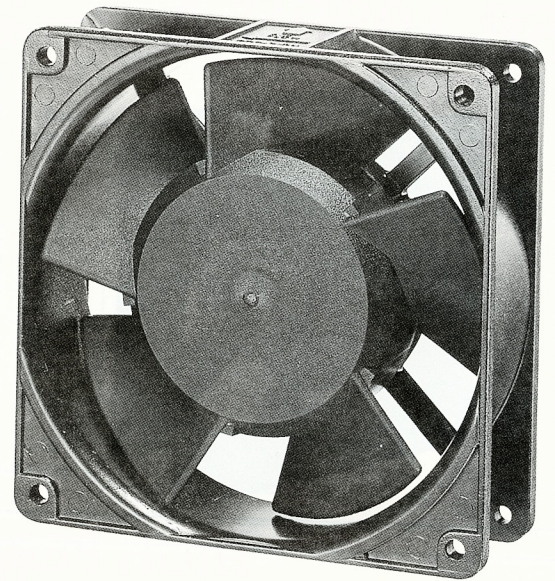

DIMENSIONS:MM

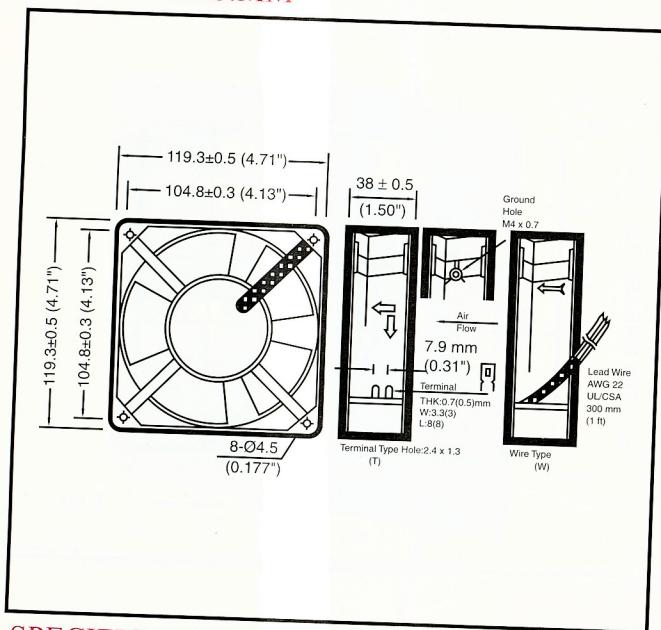

PERFORMANCE

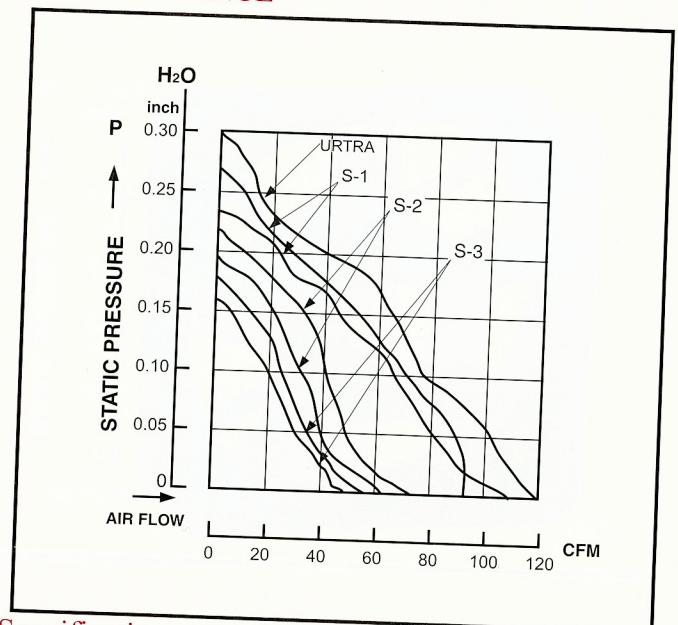

SPECIFICATIONS

Specifications are subject to change without notice

MODEL NO.	VOLT (VAC)	FREQUENCY (HZ)	AIR (CFM)	VOLUME (M ³ /MIN)	CURRENT (A)	POWER (W)	SPEED (RPM)	STATIC PRESSURE (INCH-H ₂ O)	NOISE (dBA)
**NEW									
FP-108-1 (S-ULTRA)	110/120	50/60	112/120	3.18/3.40	0.25/0.19	18/19	2700/3000	0.27/0.30	40/45
	220/240	50/60	112/120	3.18/3.40	0.14/0.12	18/19	2700/3000	0.27/0.30	40/45
FP-108-1 (S-1)	110/120	50/60	80/105	2.30/3.00	0.24/0.18	18/17	2700/3000	0.23/0.28	42/47
FP-108-1 (S-1)	220/240	50/60	80/105	2.30/3.00	0.13/0.11	18/17	2700/3000	0.23/0.28	42/47
FP-108-1 (S-2)	110/120	50/60	63/71	1.65/1.85	0.13/0.12	11/10	2200/2500	0.19/0.21	37/39
FP-108-1 (S-2)	220/240	50/60	63/71	1.65/1.85	0.11/0.09	11/10	2200/2500	0.19/0.21	37/39
FP-108-1 (S-3)	110/120	50/60	54/52	1.50/1.40	0.11/0.10	9/8	1800/2000	0.16/0.15	30/34
FP-108-1 (S-3)	220/240	50/60	54/52	1.50/1.40	0.08/0.06	9/8	1800/2000	0.16/0.15	30/34